

ARRIVAL INSTRUCTIONS

The workshop will take place at the Turku School of Economics (address: Rehtorinpellonkatu 3).

Arrival to Turku School of Economics from Kupittaa Railway Station

The closest train station to the university is Kupittaa. If you are arriving from Helsinki, Kupittaa is the final stop as the train does not continue to the main railway station due to track work. The walk from the station to the university is about 900 metres. Alternatively, you can take local bus no. 60 from “Hammasklinikka” bus stop and get off at “University (TYKS U-hospital)” stop. The bus ride only takes a couple of minutes. A single ticket is 3 € and can be purchased with contactless payment on the bus, from [the Föli mobile app](#), at service points, from ticket machines and on the bus with cash (the ticket price is 4 € if you purchase the ticket with cash on the bus). More information about the public transport lines and timetables can be found on the [Föli journey planner](#).

Note: if you are arriving from the direction of Tampere by train, the train will stop at the Turku Railway Station. The station is about 2,5 km from the Turku School of Economics. Buses 32 and 42 depart opposite the railway station (stop name “Rautatieasema”) and stop at “Vähä Hämeenkatu” stop, which is located about 600 metres from the Turku School of Economics. The location of the stop is marked on the map below. More information about the public transport lines and timetables can be found on the [Föli journey planner](#).

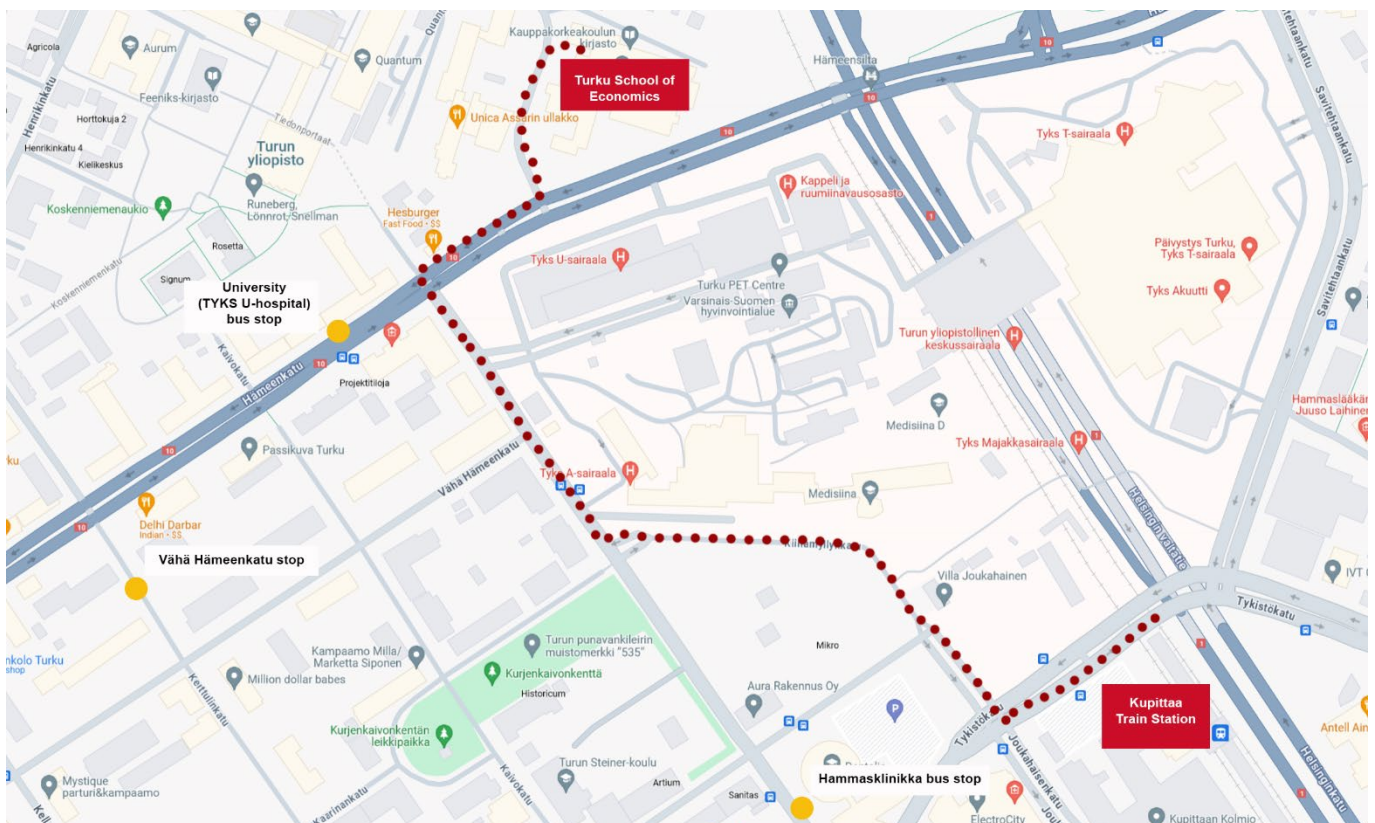

Arrival to Turku School of Economics from Turku Bus Station

If you are arriving by bus to Turku, the bus station is located about 1,5 km from the university. You can walk or take a local bus from the “Turku Bus Station” stop. Buses 60, 2(A,B,C) take you to the “University (TYKS U-hospital)” bus stop near that Turku School of Economics. The bus ride takes about 10 minutes. See information about tickets and timetables above.

Some of the long-distance buses also stop near the university (stop name: Yliopisto). The stop is only about 250 metres from the School of Economics building.



Finding the Workshop Room at the Turku School of Economics

The workshop will take place in lecture hall 7 (ls07), see map below.

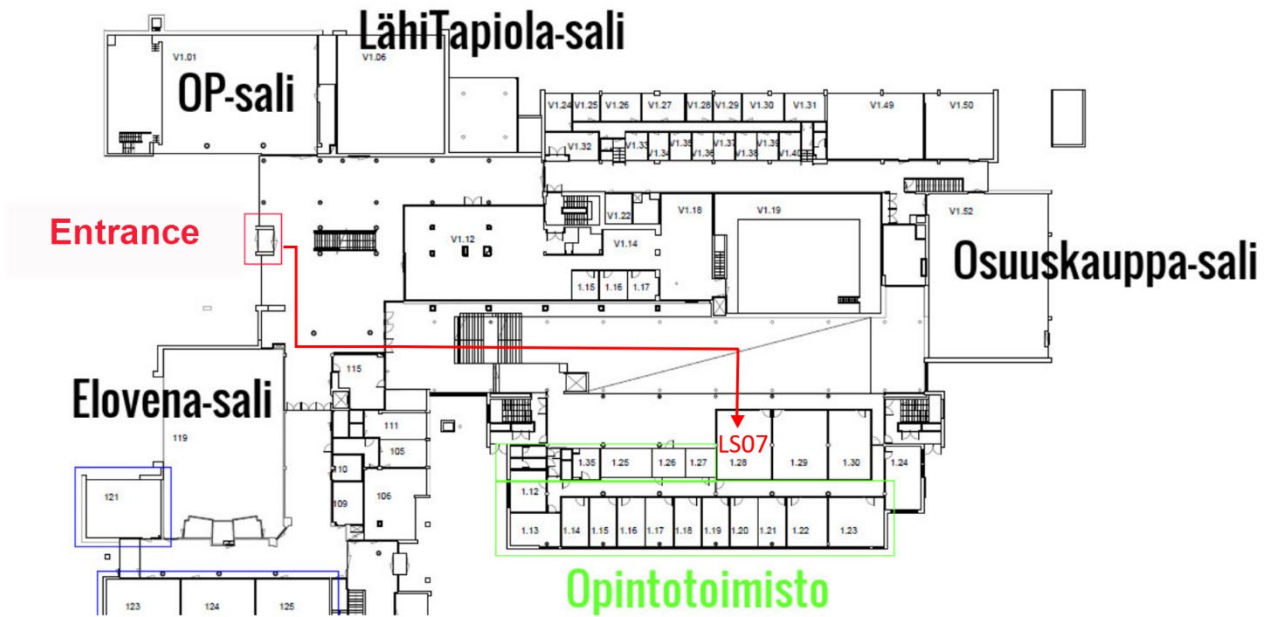

From Turku School of Economics to Original Sokos Hotel Wiklund

The workshop hotel is [Original Sokos Hotel Wiklund](#) in Turku city centre (address: Eerikinkatu 11). The hotel is about 1,5 km from the university. You can walk or take one of the local bus lines from the “University (TYKS U-hospital)” bus stop to the city centre. For example, lines 60 and 56 take you to the Market Square, right next to the hotel. See information about tickets and timetables above.

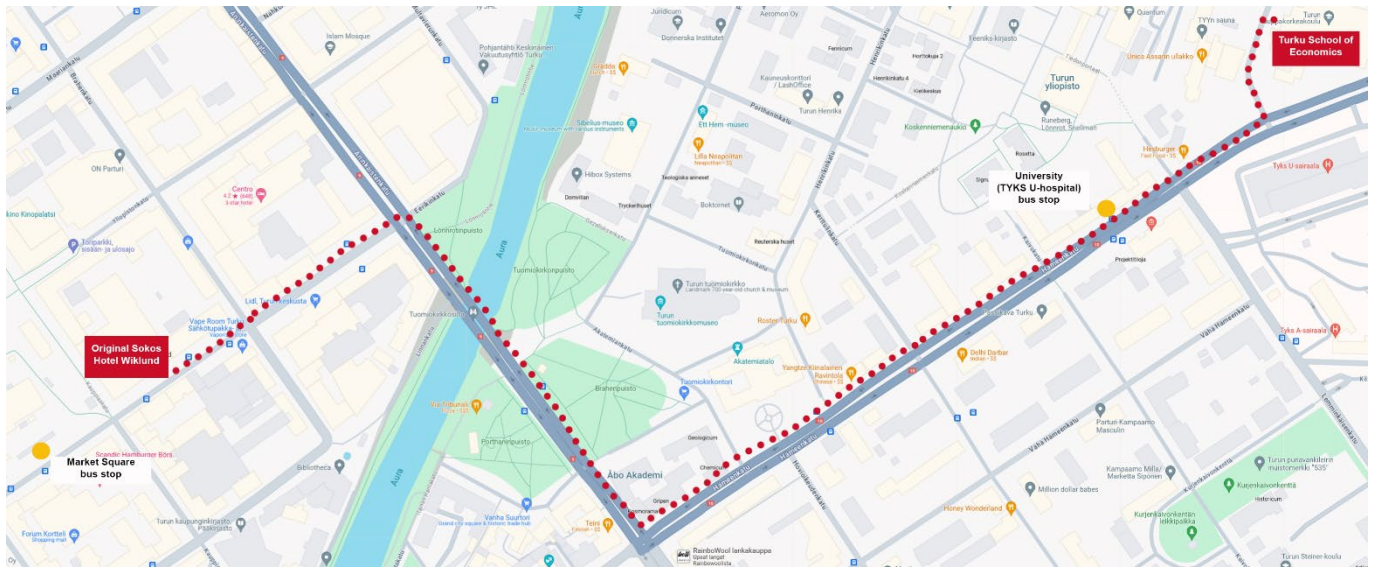

From Original Sokos Hotel Wiklund to the Workshop Dinner

The workshop dinner takes place at [Restaurant E. Ekblom](#) (address: Läntinen Rantakatu 3), in the Neuvolansali cabinet. The restaurant is located only 300 metres from the hotel.

